

Verpackt in Gurtverpackung - Tape on Reel Packaging
 Verpackungseinheit: 260 Stück - Packaging unit: 260 pcs

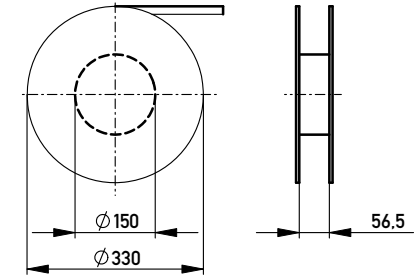

Abspulrichtung - Reel off Direction

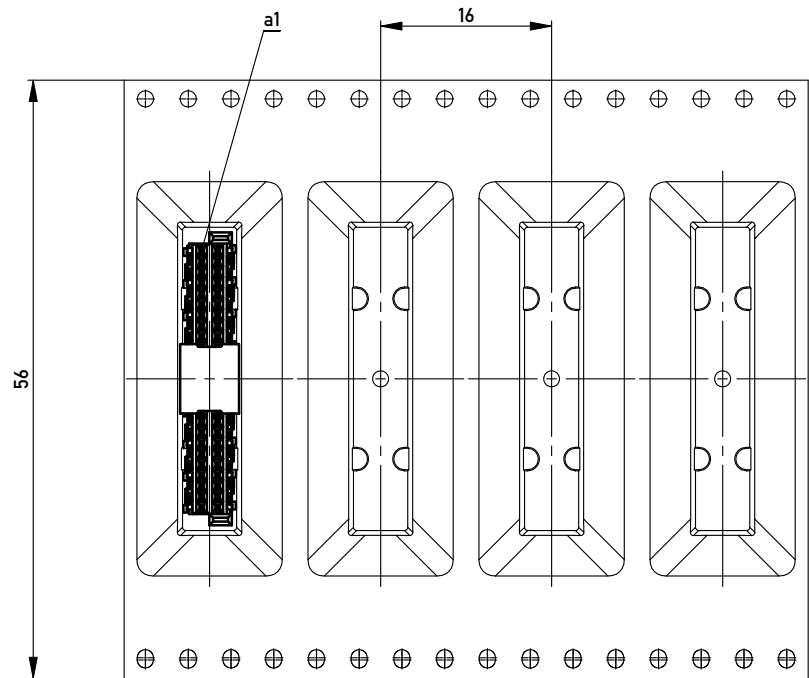

Leiterplatten-Lay-out Vorschlag / PCB-Lay-out Proposal

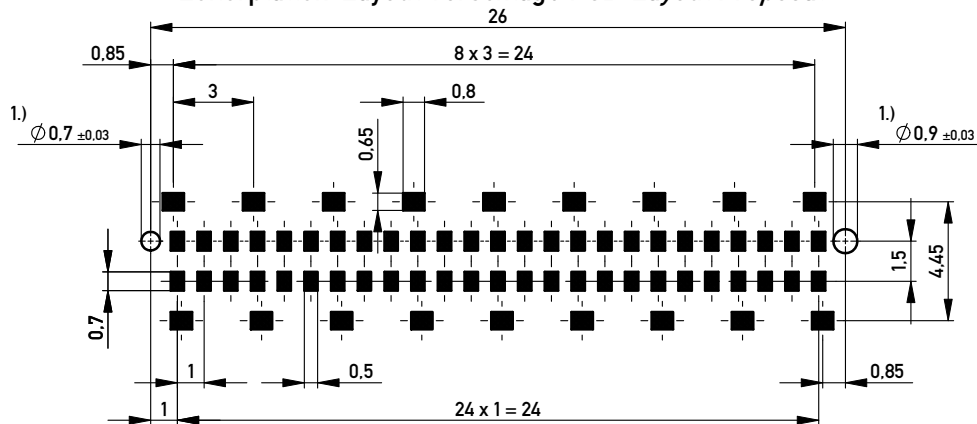

Anforderungsstufe 1
 Performance Level 1

Kontaktbereich vergoldet
 Mating Area gold plating

Anschlussbereich verzinkt 4-6µm
 Terminal Area 4-6µm tin plating

Koplanarität der Anschlüsse ≤ 0,1mm
 Coplanarity Area of Termination ≤ 0,1mm

1.) Durchmesser des Bohrers / Drill tool

Information:		Tolerances		Scale	5:1
All rights reserved. Only for Information. To ensure that this is the latest version of this drawing, please contact one of the ERNI companies before using.		All Dimensions in mm		Designation	
Subject to modification without prior notice. Drawing will not be updated.		www.ERNI.com		F08 MSpeed BlindMate 50 SMD	
ERNI		www.ERNI.com		354178	
a	01.09.2010			I	
Index	Date			A3	
Class				MSPEED	

Copyright by ERNI GmbH. Proprietary notice pursuant to ISO 16016 to be observed.